

Optical empty mould check (FLK)

Bi-Ber has been supplying camera systems for checking empty moulds for more than 25 years, much more than 100 systems are in use all over the world. As a result of permanent further development, **5 versions are currently available each for different mould widths.**

Special solutions, updates of existing systems and of course upgrades for existing moulding plants are also possible.

Bi-Ber vision systems for empty mould check are Windows-based and equipped with modern color cameras. They have a uniform multilingual software. The systems are suitable for moulds of all usual materials: polycarbonate, metal, silicone.

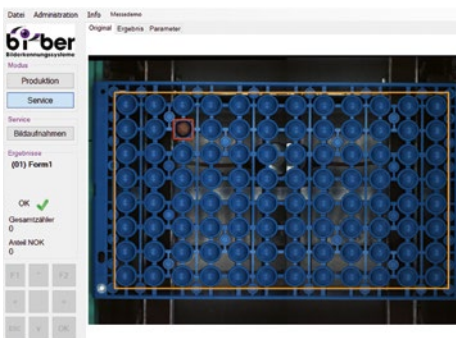
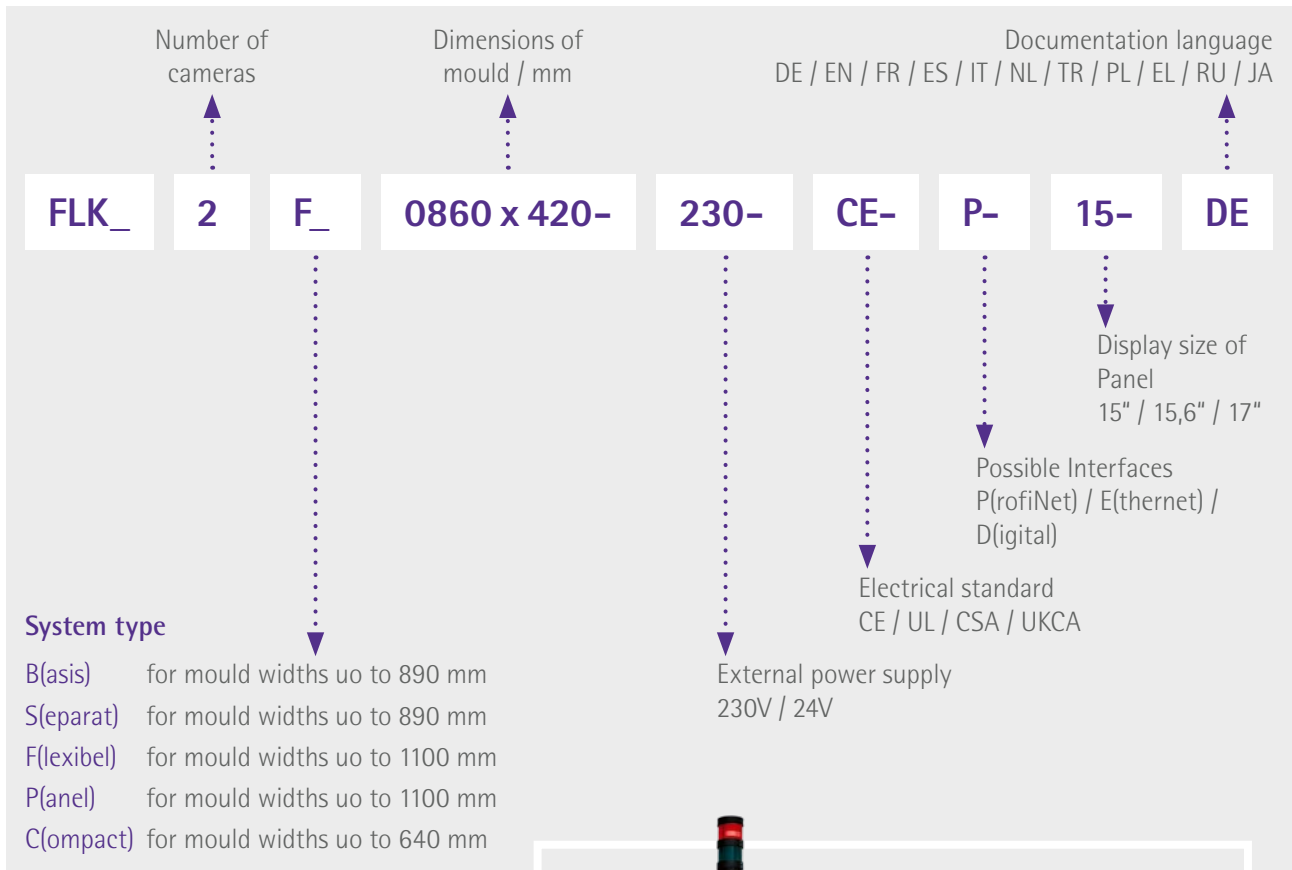

The B(asic) model FLK_xB combines all components in a stainless steel cabinet for external light shielding and has doors on both sides that also allow moulds to be removed. The system is ideal for open plants and as a retrofit.

FLK_2B_0580x406

Optical empty mould check (FLK)

S(eparate) type FLK_xS offers all the advantages of the basic system in terms of accessibility and external light shielding.

PC and electrical components are located in a separate cabinet that can be placed somewhere else.

There are no plastic parts above the product.

FLK_2S_0620x406



The **F(lexible) variant FLK_xF** allows easy retrofitting due to the reduced, adaptable housing size, the space required is limited.

The camera housing is closed and has an inspection flap and an acrylic window.

An IP67 housing is available too.

FLK_2F_1052x165

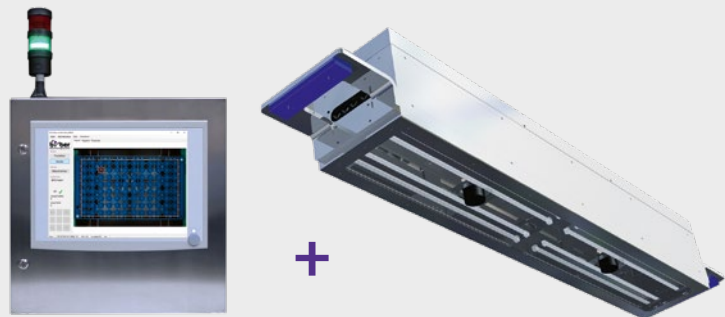

The **P(anel) version FLK_xP** no longer has an additional cabinet and signal light.

The system's PC is supplied separately for individual installation into the customer's facility.

External power supply and signals are connected to a terminal box on the camera housing.

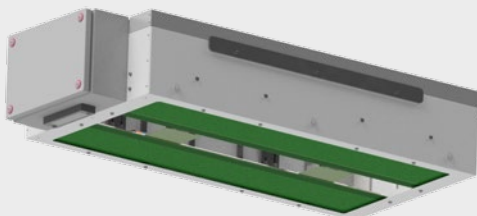

FLK_2P_0860x420

The **C(ompact) FLK_xC** system can be flexibly adjusted in its size, requires minimal installation space and all components are easily accessible.

The control box with panel PC is attached directly to the camera housing, a signal light can be saved.



FLK_1C_0425x275

Bi-Ber GmbH & Co. Engineering KG

Freiheitstraße 124/126 · D-15745 Wildau

Tel.: +49 (0)30 - 8103 222 60

info@bilderkennung.de · www.bilderkennung.de

bi-ber
Bilderkennungssysteme